



CSI250 dome housing

- ✓ dome housing for discrete surveillance
- ✓ weatherproof rating IP65 (IP66 with cable gland optional)
- ✓ fan-assisted heater
- ✓ smoked or clear semisphere
- ✓ wide range of speed dome adaptors
- ✓ available for network cameras



STL250



STS250



CSI250+STA250
-old style-



SP/B



SA/B



PT250

Dome housing for discrete surveillance

The new system of wiring combined to high quality materials and pleasant design make of the **CSI250** a product highly qualified for CCTV installation.

Available there are a wide range of pole, corner adaptors and wall, ceiling, parapet brackets, new entry is a parapet bracket "old style" painted dark grey, model **STA250** indicated for installation in historic cities.

There are, also, some adaptors for most popular speed-dome (*see data sheet on rear*), for fixed and network cameras is available the **PT250** bracket.

- DATA SHEET -

dome housing

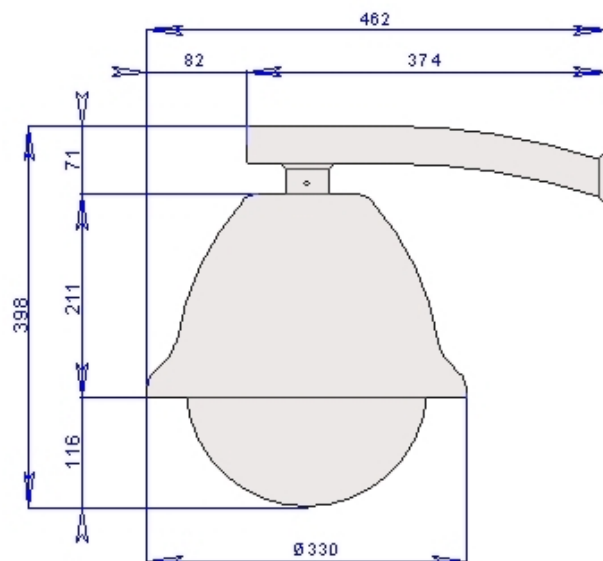

the values are in millimeters

TECHNICAL DATA

GENERAL

- body and sunshield made in aluminium
- painted with polyester powder RAL 7035 (light grey)
- stainless steel bolts and screws
- semisphere made in acrylic available clear or smoked
- PT250 bracket for fixed or network cameras (optional)
- fan assisted heater
- easy electrical connections by adjustable plate
- wide range of speed dome adaptors (see chart below)
- supplied with instruction manual
- according to RoHS compliance

ELECTRICAL

- fan assisted heater 230-110-24-12 Vac
consumption max. 30W
t on 15°C t off 22°C +/- 3°C
- power supply for fixed cameras AL250
AL250/A 230Vac -12Vdc 400mA
AL250/B 230Vac -24Vac 400mA

MECHANICAL

- external dimensions Ø330x398mm. with sunshield and ST250 bracket
- weatherproof rating IP65 (IP66 with cable gland optional)
- indoor/outdoor installations
- cable managed
- operating temperature from -20°C to +50°C
- weight 6 Kg. (with ST250 wall bracket)

RELATED PRODUCTS

- ST250** wall bracket (included on KIT versions)
- STL250** parapet bracket with junction box
- STA250** parapet bracket old style with junction box
- SP/B** pole adaptor
- SA/B** corner adaptor
- PT250** internal bracket for fixed and network cameras
- PD...** wide range of speed dome adaptors (see

MODEL	ADAPTOR FOR
Standard plate included*	PANASONIC WV-CS850, WV-CS950, WV-CS570, WV-NS320
PT250	for fixed and network cameras (see PT250 data sheet)
PD001	JVC TK-C655, TK-676, VN-655U
PD002	PANASONIC BB-HCM381
PD003	SAMSUNG SPD-2300, SPD-3000, SPD-3300 (TECHWIN)
PD004	SANYO VCC9400P, VCC9300P
PD005	SONY-HRZ50P
PD006	AXIS 231, 232
PD007	AXIS 233
PD008	AXIS 214 PTZ

Specifications are subject to change without notice, weights and dimensions are indicative.

GLOBAL PROOF S.r.l.

Via dell'Industria, 10 36013 Piovane Rocchette (VICENZA) ITALY
Phone +39.0445.396190 Fax +39.0445.395000

info@globalproof.it

www.globalproof.it

CS1250