

DATASHEET

CSX615T POE

AISI 316L stainless steel housing
powered PoE (IEEE 802.3af-802.3at compliant)

- AISI 316L stainless steel housing
- **IP69K** weatherproof rating
- slide opening system
- powered **PoE/PoE+** compliant 802.3af and 802.3at (*Italian Patent*)
- joint with 3rd axis tilt for easier orientation
- clean glass system: protection against dust deposits on the front glass
- easy fastening and positioning
- wide range of accessories



IP69K
CERTIFIED



AISI316L stainless steel housing powered by PoE

The **CSX615T** is a cylindrical weatherproof housing, entirely made of AISI 316L stainless steel with electropolishing treatment that increases the corrosion resistance. The special robust feature and design makes this housing specially indicated for tunnel installations. The **IP69K** certification give the most guarantee of protection also with high pressure waterjet cleaning (typical situation on tunnel applications).

The front cover is supplied with the exclusive “*clean glass*” system, that keeps the front glass always free of any dust deposit, so it's especially indicated for installations inside tunnels, where this problem is more prevalent.

It is supplied with a special joint, realized by Global Proof with an exclusive system that allows the third axis tilt: in this way it is possible to mount the housing also in an arched ceiling or on a wall that is not perpendicular to the ground.

This exclusive fixing system also allows both wall and ceiling mounting with the same enclosure configuration, thus ensuring flexibility and significant savings on accessories.

DATASHEET

TECHNICAL DRAWINGS

Tilt to the left
-45° max.

Tilt to the right
+45° max.

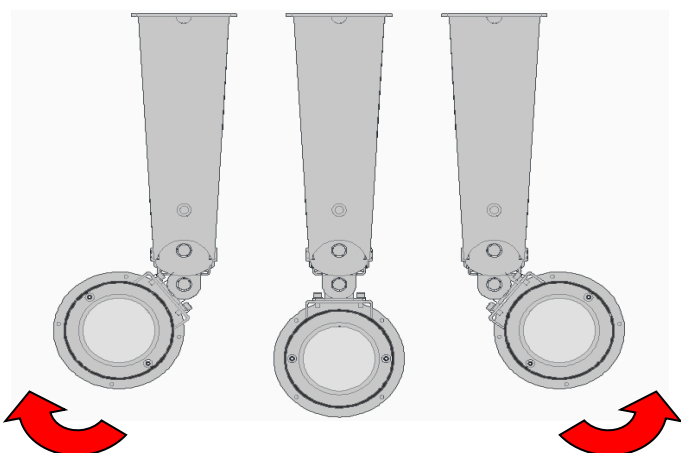
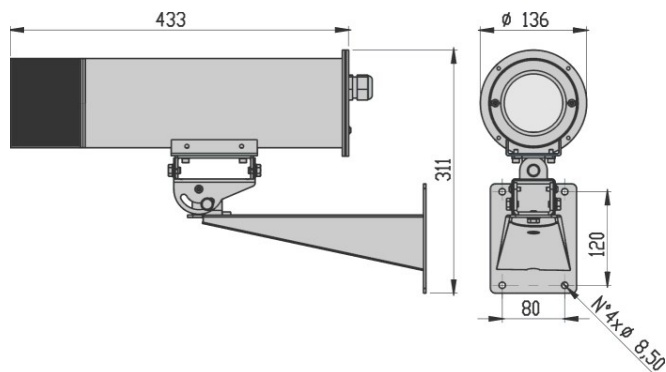
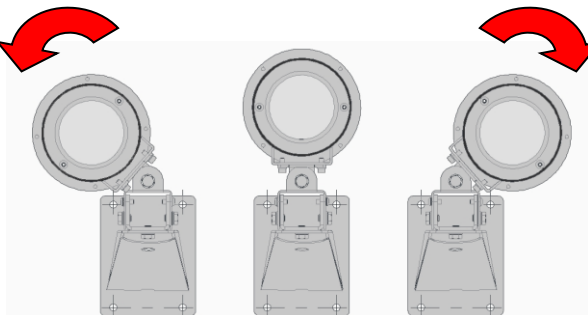

Tilt to the left
-45° max.

Tilt to the right
+45° max.

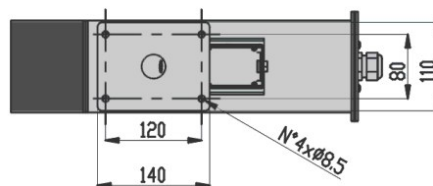
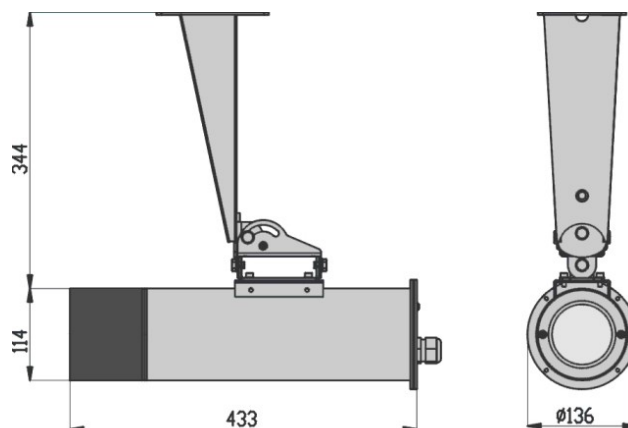

useful length

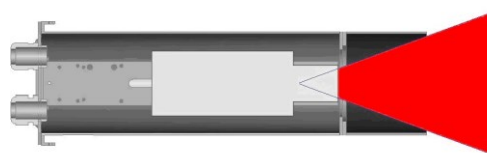
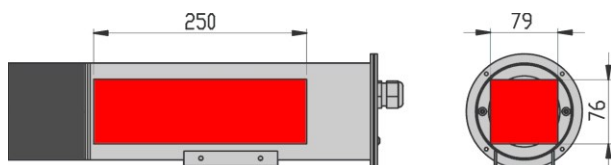

Max opening
angle 40°

top view

the values are in millimeters

Specifications are subject to change without notice, weights and dimensions are indicative.

rev. 2506

GLOBAL PROOF S.r.l.

Via dell'Industria, 10 36013 Piovane Rocchette (VICENZA) -ITALY-
phone +39.0445.396190 fax +39.0445.395000

email: info@globalproof.it

home page : www.globalproof.it

DATASHEET

TECHNICAL DATAS

GENERAL

- slide-out back cover
- stainless steel bolts and screws
- wall bracket made of stainless steel AISI 316L
- 1xM25 cable gland
- **clean glass** system that keeps the front glass always free of any dust deposit
- heater
- wide range of accessories
- supplied with instruction manual
- according to RoHS compliance

ELECTRICAL

- input data+power: PoE (802.3af/at)
- heater
max. consumption: 5W
t on +15°C t off +22°C (+/- 3°C)
- internal ventilation
max. consumption: 1W
t on +37°C t off +27°C (+/- 3°C)

MECHANICAL

- usable internal space: 79x76mm.(BxH)
- useful lenght: 250mm
- glass window: Ø 75mm.
- **IP69K** weatherproof rating (*ref. DIN 40050-9 and CEI 60529*)
- indoor/outdoor installations
- operating temperature with heater: from -20°C to +60°C (with double heater from -30°C to +60°C)
- weight: 6 Kg. (version with wall bracket included)

ACCESSORIES

- VI615** internal ventilation (pre-assembled)
RD615 double heater for low temperature (pre-assembled)

RELATED PRODUCTS

- SP/C** AISI 316L pole adaptor
SA/C AISI 316L corner adaptor
STS800 adaptor plate for ceiling mounting

code	unit weight (Kg.)	package dimensions (cm.) WxHxL	package weight (Kg.)
KIT CSX615T + ST800	6,00(tot.)	16,0 x 15,0 x 55,0 19,0 x 15,0 x 46,0	6,40 (tot.)